

WARNING

it is advisable to optimize the carburation by remapping the stock ECU or by adopting an additional ECU unit.

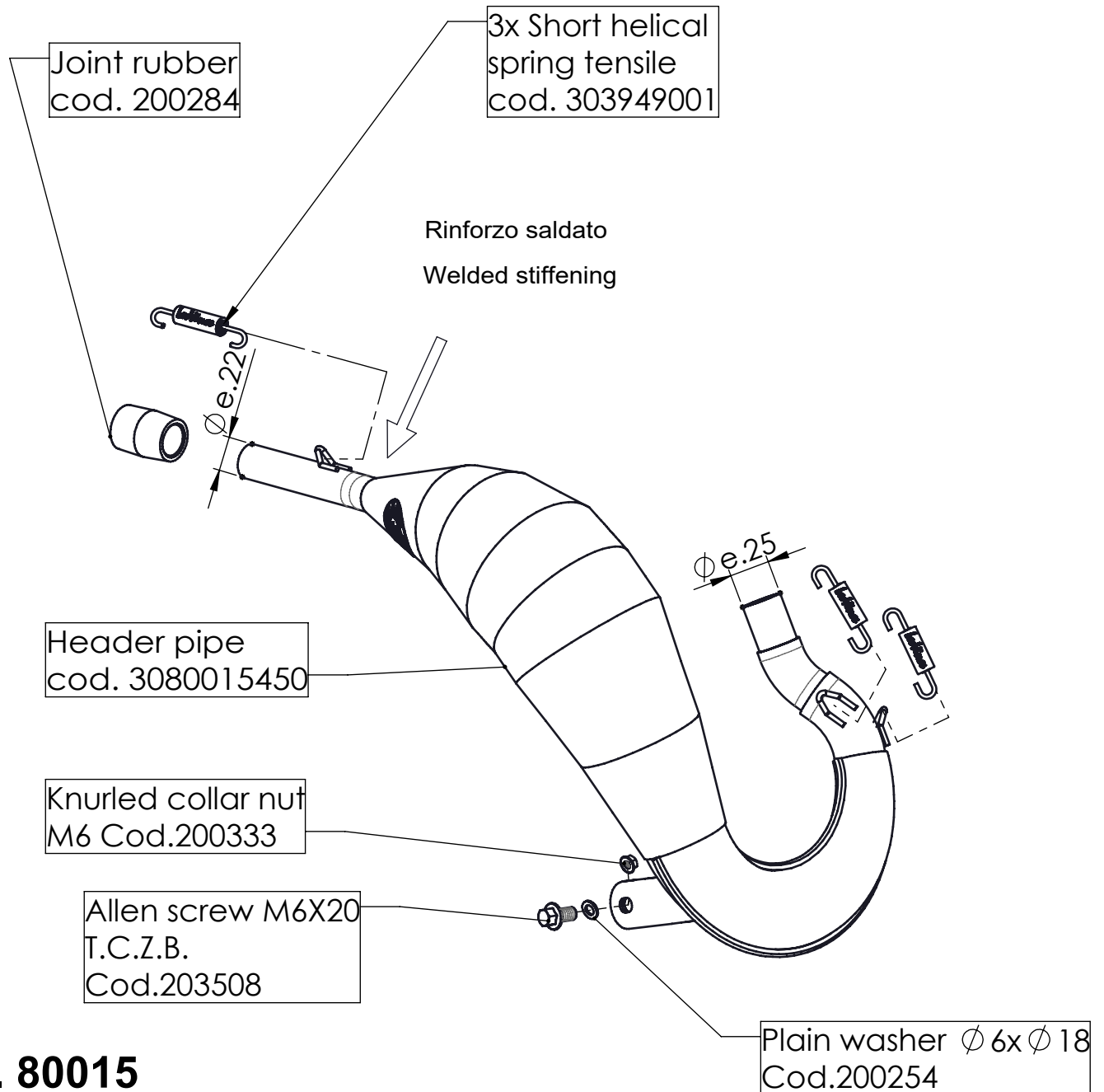

ART. 80015

FANTIC MOTOR ENDURO 50/MOTARD 50 /
COMPETITION / PERFORMANCE

(Compatible with LeoVince exhaust only ART.17002)
(DOES NOT FIT WITH STOCK SILENCER)

HEADER PIPE - STEEL